

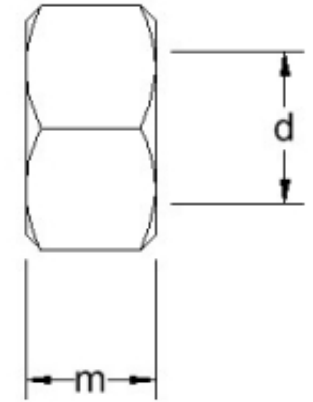

Further Information

Diameter (d)	Pitch	s	m (max)
M1.0	0.25	2.5	0.8
M1.2	0.25	3.0	1.0
M1.4	0.30	3.0	1.2
M1.6	0.35	3.2	1.3
M1.7	0.35	3.5	1.4
M2	0.40	4.0	1.6
M2.3	0.45	4.5	1.8
M2.5	0.45	5.0	2.0
M2.6	0.45	5.0	2.0
M3	0.50	5.5	2.4
M3.5	0.60	6.0	2.8
M4	0.70	7.0	3.2
M5	0.80	8.0	4.0
M6	1.00	10	5.0
M7	1.00	11	5.5
M8	1.25	13	6.5
M10	1.50	17	8.0
M12	1.75	19	10
M14	2.00	22	11
M16	2.00	24	13
M18	2.50	27	15
M20	2.50	30	16
M22	2.50	32	18
M24	3.00	36	19
M27	3.00	41	22
M30	3.50	46	24
M33	3.50	50	26
M36	4.00	55	29
M39	4.00	60	31
M42	4.40	65	34
M45	4.50	70	36
M48	5.00	75	38
M52	5.00	80	42
M56	*	*	*

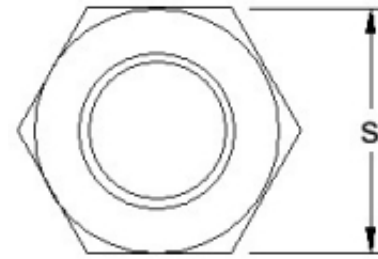

 PRECISION TECHNOLOGY SUPPLIES <small>Stainless Steel Industrial Fastenings & Precision Turned Parts</small>	Part No. A934025
www.pts-uk.com +44 (0)1342 410758	M2.5 HEXAGON FULL NUT DIN 934 A2 ST/ST
Information in this drawing is provided for reference only	